

Mini HI-FI Component System

Operating Instructions

Getting Started

Disc

Tuner

USB Device

Other Operations

Additional Information

WARNING

To reduce the risk of fire or electric shock, do not expose this apparatus to rain or moisture.

To reduce the risk of fire, do not cover the ventilation opening of the apparatus with newspapers, tablecloths, curtains, etc.

Do not place the naked flame sources such as lighted candles on the apparatus.

To reduce the risk of fire or electric shock, do not expose this apparatus to dripping or splashing, and do not place objects filled with liquids, such as vases, on the apparatus. As the main plug is used to disconnect the unit from the mains, connect the unit to an easily accessible AC outlet. Should you notice an abnormality in the unit, disconnect the main plug from the AC outlet immediately.

Do not install the appliance in a confined space, such as a bookcase or built-in cabinet.

Do not expose batteries or apparatus with battery-installed to excessive heat such as sunshine, fire or the like.

The unit is not disconnected from the mains as long as it is connected to the AC outlet, even if the unit itself has been turned off.

Excessive sound pressure from earphones and headphones can cause hearing loss.

CAUTION

The use of optical instruments with this product will increase eye hazard.

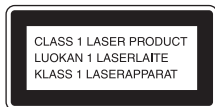

This appliance is classified as a CLASS 1 LASER product. This marking is located on the rear exterior.

License and Trademark Notice

- “WALKMAN” and “WALKMAN” logo are registered trademarks of Sony Corporation.
- MPEG Layer-3 audio coding technology and patents licensed from Fraunhofer IIS and Thomson.
- Windows Media is either a registered trademark or trademark of Microsoft Corporation in the United States and/or other countries.
- This product contains technology subject to certain intellectual property rights of Microsoft. Use or distribution of this technology outside of this product is prohibited without the appropriate license(s) from Microsoft.

Table of Contents

Guide to parts and controls4

Getting Started

Hooking up the system
securely7

Setting the clock.....8

Disc

Playing an AUDIO CD/MP3
disc9

Using play mode9

Tuner

Listening to the radio11

Receiving RDS broadcasts.....12

USB Device

Before using the USB device
with this system.....12

Transferring music from a
disc13

Playing a file15

Other Operations

Adjusting the sound 16

Using the timers 16

Changing the display..... 17

Changing the illumination
brightness 17

Using optional equipment 18

Deactivating the buttons on the
unit (Child Lock)..... 18

Additional Information

Playable discs 19

Troubleshooting 20

Messages 23

Precautions 24

Specifications 25

Guide to parts and controls

This manual mainly explains operations using the remote control, but the same operations can also be performed using the buttons on the unit having the same or similar names.

Unit

- Front view

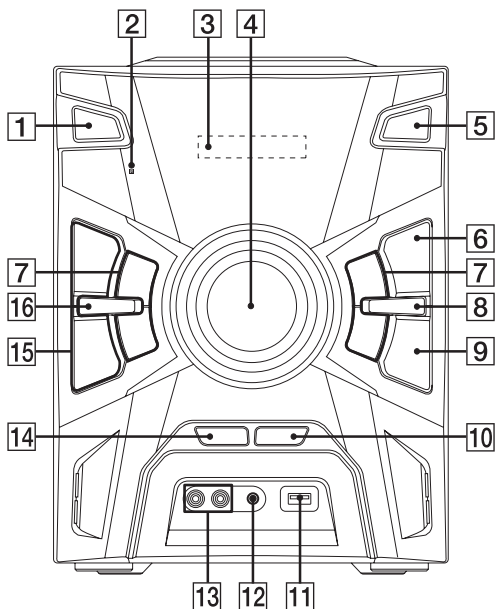

- Top view

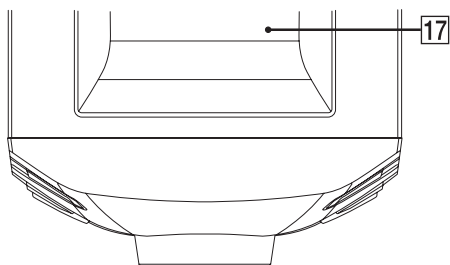

Remote control RM-SCU37B

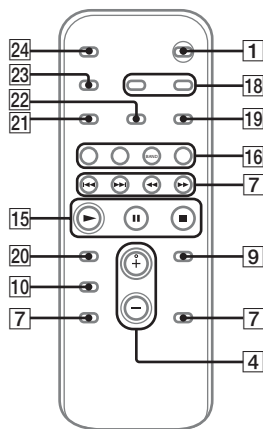

1

I/O (on/standby)

Turn on the system, or set it to standby mode.

2

Remote control sensor

3

Display panel

4

Unit: VOLUME

Remote control: VOLUME +*/-

Adjust the volume.

* The VOLUME + button has a tactile dot. Use the tactile dot as a reference when operating the system.

5



Insert or eject a disc.

6

REC TO USB

Transfer music from a disc to the connected optional USB device.

7

Folder +/- (select folder)

Select a folder on an MP3 disc or a USB device.

◀◀/▶▶ (rewind/fast forward)

Hold down to find a point in a track or file during playback.

Remote control: ←/→

Select the menu items.

Unit: ◀◀/▶▶

Remote control: ◀◀/▶▶

Select a track or file.

Unit: TUNING +/-

Remote control: +/- (tuning)

Tune to the station you want.

8

OPTIONS (page 13, 15, 16, 17, 23)

Enter or exit the option menus.

9

ENTER

Enter the settings.

10

EQ (page 16)

Select a preset sound effect.

11

USB (USB) port

Connect an optional USB device.

12

PHONES jack

Connect the headphones.

13

DVD/PC IN L/R jacks

Connect to the audio output jacks of an audio/video equipment.

14

BASS BOOST (page 16)

Select the Bass Boost effect.

Continued

15

Unit: ► **II** (play/pause)

Remote control: ► (play),
II (pause)

Start or pause playback.

To resume playback of the USB device,
press ► **II** or ► .

■ (stop)

Stop playback or transferring.

Press ■ twice to cancel resume playback
of the USB device.

16

FUNCTION

Select a function.

Remote control: USB

Select the USB function.

Remote control: CD

Select the CD function.

Remote control: TUNER/BAND

Select the TUNER function.

Select the FM or AM band during
TUNER function.

17

Disc tray

18

**CLOCK/TIMER SELECT (page 16,
17)**

CLOCK/TIMER SET (page 8, 16)

Set the clock and the Play Timer.

19

REPEAT/FM MODE

Listen to a disc, a USB device, a single
track or file repeatedly (page 10, 15).

Select the FM reception mode (monaural
or stereo) (page 11).

20

CLEAR

Delete the last step from the program list.

21

TUNER MEMORY (page 11)

Preset the radio station.

22

PLAY MODE/TUNING MODE

Select the play mode of an AUDIO CD,
MP3 disc or a USB device (page 9, 10, 14,
15).

Select the tuning mode (page 11).

23

DISPLAY

Change the information on the display
panel.

24

SLEEP (page 16)

Set the Sleep Timer.

Hooking up the system securely

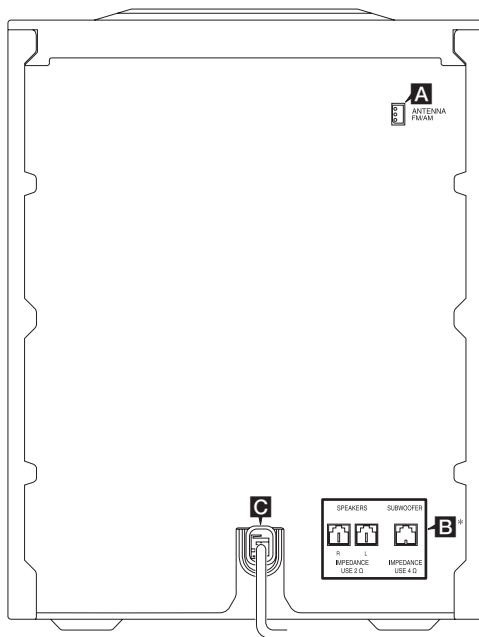

* Subwoofer for MHC-EX990 only.

A Antennas

Find a location and an orientation that provide good reception when you set up the antennas.

Keep the antennas away from the speaker cords, the power cord and the USB cable to avoid picking up noise.

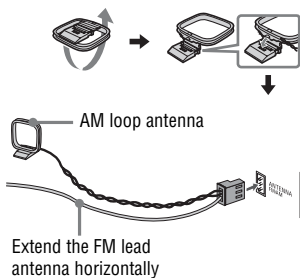

Continued 

B Speakers

Example:

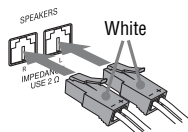

Notes

- Be sure to use only the supplied speakers.
- When connecting speaker cords, insert the connector straight into the terminals.

C Power

Plug the power cord into a wall socket. The demonstration appears in the display panel. Press **I/⏻** to turn on the system and the demonstration automatically ends. If the supplied adaptor on the plug does not fit your wall outlet, detach it from the plug (only for models equipped with an adaptor).

Inserting batteries

Insert the two supplied R6 (size AA) batteries, matching the polarities shown below.

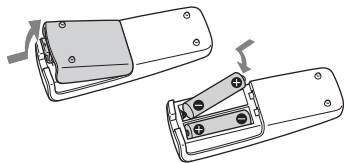

Notes

- Do not mix an old battery with a new one or mix different types of batteries.
- If you do not use the remote control for a long period of time, remove the batteries to avoid damage from battery leakage and corrosion.

Setting the clock

You cannot set the clock in Power Saving Mode.

1 Press **I/⏻** to turn on the system.

2 Press **CLOCK/TIMER SET**.

If “PLAY SET” appears in the display panel, press **◀/▶** repeatedly to select “CLOCK”, then press **ENTER**.

3 Press **◀/▶** repeatedly to set the hour, then press **ENTER**.

4 Press **◀/▶** repeatedly to set the minutes, then press **ENTER**.

Playing an AUDIO CD/ MP3 disc

- 1 Press CD.
- 2 Press **▲** on the unit to open the disc tray.
- 3 Load a disc with the label side facing up.

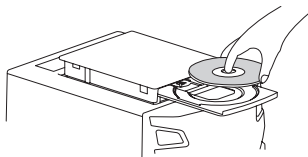

- 4 Press **▲** on the unit to close the disc tray.
- 5 Press **▶** to start playback.

Notes on playing discs

- The system can recognize up to
 - 255 folders (including root folder).
 - 512 MP3 files.
 - 8 folder levels (tree structure of files).
- CD-TEXT information is not supported.

Using play mode

Playing in original order (Normal Play)

Press PLAY MODE repeatedly when playback is stopped.

- (blank): a disc
- FLDR*: all MP3 files in the folder on the disc

* When playing an AUDIO CD, “FLDR” performs the same operation as Normal Play mode.

Playing in random order (Shuffle Play)

Press PLAY MODE repeatedly when playback is stopped.

- SHUF: shuffle a disc
- FLDR SHUF*: shuffle all MP3 files in the folder on the disc

* When playing an AUDIO CD, “FLDR SHUF” performs the same operation as “SHUF” play mode.

Note

When you turn off the system, the selected Shuffle Play is cleared and the play mode returns to Normal Play.

Creating your own program (Program Play)

You can make a program of up to 25 steps in the order you want them to be played back.

1 For CD function:

Press CD.

For USB function:

Press USB.

2 When playback is stopped, press PLAY MODE repeatedly until "PGM" lights up in the display panel.

3 (Audio files only) Press +/- repeatedly to select a folder.

4 Press repeatedly to select the track or file you want, then press ENTER.

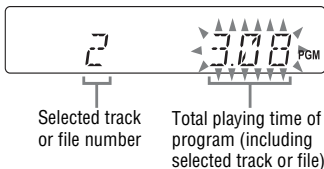

"--:--" appears when the total playing time exceeds 100 minutes for an AUDIO CD or when you program an audio file.

5 Repeat steps 3 and 4 to program additional tracks or files.

6 Press to start Program Play.

To cancel Program Play

When playback is stopped, press PLAY MODE repeatedly until "PGM" disappears from the display panel.

To delete the last step from the program list

Press CLEAR when playback is stopped.

Notes



- (CD function only) The program list remains available until you open the disc tray.
- (USB function only) The program list is cleared when you:
 - perform the erase operation.
 - remove the USB device.
 - switch the USB memory select.

To view program information, such as total track number of the program

Press DISPLAY repeatedly.

Playing repeatedly (Repeat Play)

Press REPEAT repeatedly.

- : repeat all tracks or files
- : repeat a track or file

Listening to the radio

1 Press TUNER/BAND repeatedly to select FM or AM band.

2 For automatic scanning:

Press TUNING MODE repeatedly until "AUTO" lights up in the display panel. Then, press +/-.

Scanning stops automatically when a station is tuned in, and then "TUNED" and "ST" (for FM stereo programs only) light up in the display panel.

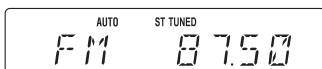

If "TUNED" does not light up and scanning does not stop, press ■ to stop scanning. Then, perform manual tuning (below).

For manual tuning:

Press TUNING MODE repeatedly until "AUTO" and "PRESET" disappear from the display panel.

Then, press +/- repeatedly to tune to the station you want.

Tip

To reduce static noise on a weak FM stereo station, press FM MODE repeatedly until "MONO" lights up in the display panel.

To change the AM tuning interval (Except Russian model)

The default setting for AM tuning interval is 9 kHz (or 10 kHz for some areas). You cannot change the AM tuning interval in Power Saving Mode.

1 Press TUNER/BAND repeatedly to select AM band.

2 Press I/⏻ to turn off the system.

3 Press DISPLAY to display the clock or demo.

4 Hold down TUNING + on the unit, then press I/⏻ on the unit. "9K STEP" or "10K STEP" appears in the display panel.

When you change the interval, all the AM preset stations are erased.

Presetting radio stations

You can store up to 20 FM and 10 AM stations as your favorite stations.

1 Tune to the station you want.

2 Press TUNER MEMORY.

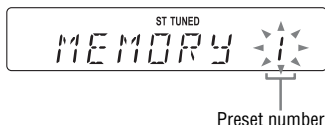

3 Press +/- repeatedly to select the preset number you want, then press ENTER.

"COMPLETE" appears in the display panel. The station is stored.

The preset stations are retained for about half a day even if you disconnect the power cord or if a power failure occurs.

To tune to a preset station

Press TUNING MODE repeatedly until "PRESET" lights up in the display panel. Then, press +/- repeatedly to select the preset number you want.

Receiving RDS broadcasts

This system allows you to use Radio Data System (RDS), which enables radio stations to send additional information along with the regular programming signal. This system offers convenient RDS features, such as Program Service name display. RDS is available only for FM stations.*

* Not all FM stations provide RDS service, nor do they provide the same type of services. If you are not familiar with the RDS services in your area, check with your local radio stations for details.

Simply select a station on the FM band.

When you tune to a station that provides RDS services, the Program Service name appears in the display panel. You can check the RDS information by pressing DISPLAY repeatedly.

Note

RDS may not work properly if the station you tuned to is not transmitting the RDS signal or if the signal strength is weak.

USB Device

Before using the USB device with this system

Check the websites below for the information about compatible USB devices.

For customers in Russia:

<<http://support.sony-europe.com/>>

For customers in Latin America:

<<http://esupport.sony.com/LA>>

For customers in other countries/regions:

<<http://www.sony-asia.com/support>>

Note on the maximum number of audio files and folders on a USB device

This system cannot transfer or playback audio files and folders of the USB device in the following cases.

- When the number of audio files in a folder exceeds 999.
- When the number of audio files in a USB device exceeds 5,000.
- When the number of folders in a USB device exceeds 255 (excluding empty folders).

Note

Do not remove the USB device during transferring or erase operations. Doing so may corrupt the data on the USB device or damage the USB device itself.

To select the playback source or transferring destination

If the USB device has more than one memory (for example, internal memory and a memory card), you can select which memory to use as a playback source or transferring destination.

Note

You cannot select a memory during playback or transferring. Make sure to select a memory before starting playback or transferring.

- 1 Connect a USB device to the ψ port on the unit.
- 2 Press USB.
- 3 Press OPTIONS on the unit when playback is stopped.
- 4 Press $\blacktriangleleft/\blacktriangleright$ to select "MEM SEL", then press ENTER.
- 5 Press $\blacktriangleleft/\blacktriangleright$ to select the memory you want, then press ENTER.
- 6 Start playback the audio files of the selected memory or start transferring.

To use the system as a battery charger

You can use the system as a battery charger for USB devices that have a rechargeable function when the system is turned on.

The charging begins when the USB device is connected to the ψ port on the unit. The charging status appears in the USB device's display. For details, refer to the operating instructions of your USB device.

Note

You cannot use the system as a battery charger when the system is turned off.

Transferring music from a disc

You can transfer music from a disc (AUDIO CD or MP3 disc only) to a USB device.

You can easily transfer all the music on a disc to a USB device (CD SYNC Transferring). You can also transfer a single track or MP3 file during playback (REC1 Transferring).

The audio format of files transferred by this system is MP3.

Note on copyright-protected content

The transferred music is limited to private use only. Use of the music beyond this limit requires permission of the copyright holders.

Notes

- When transferring from an AUDIO CD, the tracks are transferred as 128 kbps MP3 files. When transferring from an MP3 disc, MP3 files are transferred with the same bit rate as the original MP3 files.
- USB transferring is disabled while the disc tray is open.

- 1 Connect a USB device to the ψ port on the unit.
- 2 Press CD.
- 3 Load the disc you want to transfer.

Continued 

4 For CD SYNC Transferring:

To transfer only your favourite tracks or MP3 files, create your own program beforehand (page 10).

To transfer MP3 files in a specific folder, press PLAY MODE repeatedly until "FLDR" lights up in the display panel when playback is stopped. Then, press \square +/- repeatedly to select the folder you want.

Note

If you start transferring in Shuffle Play or Repeat Play, the selected play mode is automatically changes to Normal Play.

For REC1 Transferring:

Select the track or MP3 file you want to transfer, then start playback.

5 Press REC TO USB on the unit.

"PUSH ENTER" appears in the display panel.

6 Press ENTER.

Transferring starts when "DO NOT REMOVE" appears in the display panel.

For CD SYNC Transferring:

When the transferring is completed, access to the USB device and the disc stop automatically.

For REC1 Transferring:

When the transferring is completed, the disc continues playback.

Folder and file generation rules

When first transferring to a USB device, a "MUSIC" folder is created directly below the "ROOT" and a transfer mode-oriented folder ("CD-DA", "CD-MP3", "REC1" or "PROGRAM") is created within the "MUSIC" folder.

Folders and files are generated within any of the transfer mode-oriented folders as follows.

CD SYNC Transferring*

Transferring source	Folder name	File name
MP3	Same as the transferring source	
AUDIO CD	"CDDA001"***	"TRACK001"***

REC1 Transferring

Transferring source	Folder name	File name
MP3	"REC1"	Same as the transferring source
AUDIO CD		"TRACK001"***

* In Program Play mode, the folder name is "PGM_xxx", and the file name depends on the transferring source.

** Folder and file numbers are assigned serially thereafter.

Notes on transferring

- While transferring from an MP3 disc, no sound is output and "HI-SPEED" appears in the display panel.
- CD-TEXT information is not transferred in the created MP3 files.
- Transferring stops automatically if:
 - the USB device runs out of space during transferring.
 - the number of audio files and folders on the USB device reaches the limit for the number that the system can recognize.
 - the function is changed.
- If a folder or file that you are trying to transfer already exists on the USB device with the same name, a sequential number is added after the name without overwriting the original folder or file.
- You cannot open the disc tray, select track or file, pause playback or find a point in the track or file during transferring.
- When transferring music to a Walkman® using "Media Manager for WALKMAN", be sure to transfer in MP3 format.
- When connecting a Walkman® to the system, be sure to connect after the display "Creating Library" or "Creating Database" on the Walkman® has disappeared.

Playing a file

The audio formats that can be played back by this system are as follows:

- MP3: file extension “.mp3”
- WMA: file extension “.wma”
- AAC: file extension “.m4a”, “.mp4” or “.3gp”

If the audio files have the above file extension but are not the respective formats, the system may produce noise or may malfunction.

WMA and AAC files downloaded from an online music store may not be played back on this system.

1 Press **USB**.

2 Connect a USB device to the ψ port on the unit.

The display changes as follows:

“READING” → USB device name
→ “xxxFLDR”*

* “xxx” represent number of folders.

3 Press **▶**.

To erase audio files or folders from the USB device

1 Connect a USB device to the ψ port on the unit.

2 Press **USB** when playback is stopped.

3 Press **◀▶** or **📁 +/-** repeatedly to select the audio file or folder.

4 Press **OPTIONS** on the unit.

5 Press **◀▶** to select “ERASE”, then press **ENTER**. “FOLDER ERASE” or “TRACK ERASE” appears in the display panel.

6 Press **ENTER**. “COMPLETE” appears in the display panel.

Using play mode

Playing in original order (Normal Play)

Press **PLAY MODE** repeatedly when playback is stopped.

- (blank): a USB device
- **FLDR**: all audio files in the folder on the USB device

Playing in random order (Shuffle Play)

Press **PLAY MODE** repeatedly when playback is stopped.

- **SHUF**: shuffle a USB device
- **FLDR SHUF**: shuffle all audio files in the folder on the USB device

Note

When you turn off the system, the selected Shuffle Play is cleared and the play mode returns to Normal Play.

Creating your own program (Program Play)

See page 10.

Playing repeatedly (Repeat Play)

Press **REPEAT** repeatedly.

- **↺**: repeat all audio files on a USB device
- **↺ 1**: repeat an audio file

Notes on the USB device

- The playback order for the system may differ from the playback order of the connected digital music player.
- Be sure to turn off the system before removing the USB device. Removing the USB device while the system is turned on may corrupt the data on the USB device.
- You cannot erase audio files and folders in Shuffle Play or Program Play.

Other Operations

Adjusting the sound

To	Do this
Reinforce the bass and create a more powerful sound	Press BASS BOOST on the unit.
Select a preset sound effect	Press EQ repeatedly. To cancel, select "FLAT".

To turn on the subwoofer (MHC-EX990 only)

- 1 Press **OPTIONS** on the unit.
- 2 Press **◀◀/▶▶** repeatedly to select "S-WOOFER", and then press **ENTER**.
- 3 Press **◀◀/▶▶** repeatedly to select "SW ON", and then press **ENTER**.
To turn off the subwoofer, select "SW OFF", and then press **ENTER**.

Using the timers

The system offers two timer functions. If you use both timers, the Sleep Timer has priority.

Sleep Timer

You can fall asleep to music. The system turns off after the preset time.

Press **SLEEP** repeatedly.

If you select "AUTO", the system automatically turns off after the current disc or USB device stops, or within 100 minutes.

To cancel Sleep Timer

Press **SLEEP** repeatedly to select "OFF".

Play Timer

Make sure you have set the clock. You can wake up to disc, tuner or USB device at a preset time.

1 Prepare the sound source, then press **VOLUME +/-** to adjust the volume.

To start from a specific track or file, create your own program (page 10).

2 Press **CLOCK/TIMER SET**.

3 Press **◀◀/▶▶** repeatedly to select "PLAY SET", then press **ENTER**.

4 Set the time to start playback.

Press **◀◀/▶▶** repeatedly to set the hour/minute, then press **ENTER**.

5 Use the same procedure as in step 4 to set the time to stop playback.

6 Press **◀◀/▶▶** repeatedly to select the sound source you want, then press **ENTER**.

7 Press **I/⏻** to turn off the system.

To check the timer setting or activate the timer again

Press **CLOCK/TIMER SELECT**, press **◀◀/▶▶** repeatedly to select "PLAY SEL", then press **ENTER**.

To cancel the timer

Press CLOCK/TIMER SELECT, press **◀◀/▶▶** repeatedly to select “OFF”, then press ENTER.

Notes

- The system turns on before the preset time. If the system is turned on at the preset time or if “STANDBY” flashes in the display panel, the Play Timer will not play.
- Do not operate the system from the time the system turns on until the playback starts.

Changing the display

Changing the display mode

Press **DISPLAY** repeatedly while the system is turned off.

Demonstration

The display changes and the indicator flashes even when the system is turned off.

No display (Power Saving Mode)

The display is turned off to conserve power. The timer and clock continue to operate. You cannot turn on the system by pressing the function buttons.

Clock

The clock display automatically turns to Power Saving Mode after a few seconds.

Changing the illumination brightness

To	Do this
Change the brightness of the illumination around the VOLUME control	<ol style="list-style-type: none"> 1 Press OPTIONS on the unit. 2 Press ◀◀/▶▶ repeatedly to select “ILLUMI”, and then press ENTER. 3 Press ◀◀/▶▶ repeatedly to select the setting you want, and then press ENTER.

Viewing information in the display panel

Press **DISPLAY** repeatedly when the system is turned on.

You can view the information as follows:

- For AUDIO CD:
 - The elapsed playing time and remaining playing time during playback.
 - The total playing time when playback is stopped.
- For audio files:
 - The elapsed playing time, file name and folder name.
 - The title, artist and album information.

Note

The elapsed playing time of an audio file encoded using a VBR (variable bit rate) is not displayed correctly.

Using optional equipment

- 1** Connect an optional audio/video equipment to the DVD/PC IN L/R jacks on the unit using an audio analog cord (not supplied).
- 2** Press **VOLUME** – repeatedly until “VOL MIN” appears in the display panel.
- 3** Press **FUNCTION** repeatedly to select “DVD/PC”.
- 4** Start playing the connected equipment and adjust the volume.

Note

Make sure to turn down the volume to minimum level before connecting or disconnecting the equipment. Otherwise, noise may be generated, the system may malfunction, or “PROTECT EXX” may appear in the display panel (page 20).

Deactivating the buttons on the unit

(Child Lock)

You can deactivate the buttons on the unit (except **I/⏻**) for preventing misoperation, such as child mischief.

Hold down ■ on the unit for more than 5 seconds.

“CHILD LOCK ON” appears in the display panel.

You can only operate the system using the buttons on the remote control.

To cancel, hold down ■ on the unit for more than 5 seconds until “CHILD LOCK OFF” appears in the display panel.

Note

Child Lock function will be canceled when you disconnect the power cord.

Playable discs

- AUDIO CD
- CD-R/CD-RW
 - audio data
 - MP3 files that conforms to ISO9660 Level 1/Level 2, or Joliet (expansion format).

Notes

- MP3 (MPEG 1 Audio Layer-3) is a standard format defined by ISO (International Organization for Standardization) which compresses audio data. MP3 files must be in MPEG 1 Audio Layer-3 format.
- The system can only play back MP3 files that have a file extension of “.mp3”.

Discs that cannot be played back

- CD-ROM
- CD-R/CD-RW which has the following conditions:
 - Recorded in MP3 PRO format.
 - Recorded in multisession that have not ended by “closing the session”
 - Recorded with an incompatible recording device
 - Poor recording quality
 - Scratches or dirty
 - Finalized incorrectly
- Discs of non-standard shape (e.g., heart, square, star and etc.)
- Discs that have adhesive tape, paper, or sticker attached to them
- Rental or used discs with attached seals where the glue extends beyond the seal
- Discs that have labels printed using ink that feels tacky when touched

Note on DualDiscs

A DualDisc is a two sided disc product which mates DVD recorded material on one side with digital audio material on the other side. However, since the audio material side does not conform to the Compact Disc (CD) standard, playback on this product is not guaranteed.

Music discs encoded with copyright protection technologies

This product is designed to play back discs that conform to the Compact Disc (CD) standard. Recently, various music discs encoded with copyright protection technologies are marketed by some record companies. Please be aware that among those discs, there are some that do not conform to the CD standard and may not be playable by this product.

Notes on playing multisession discs

- This system can play back multisession discs when an MP3 file is contained in the first session. Any subsequent MP3 files recorded in later sessions can also be played back.
- If the first session is recorded in AUDIO CD format, only the first session will be played back.

Troubleshooting

Should you encounter a problem with your system, find your problem in the troubleshooting checklist below and take the corrective action.

If the problem persists, consult your nearest Sony dealer.

Note that if the service personnel changes some parts during repair, these parts may be retained.

If “PROTECT EXX” (X is a number) appears in the display panel

Immediately unplug the power cord, and check the following items.

- Are you using only the supplied speakers?
- Are the + and – speaker cords short-circuited?
- Is anything blocking the ventilation holes of the unit?

After checking the above items and fixing any problems, plug in the power cord again and turn on the system. If the issue persists, consult your nearest Sony dealer.

General

The clock or timer setting is canceled.

- The power cord is disconnected or a power failure occurred. Set the clock (page 8) and timer (page 16) again.

There is no sound.

- Adjust the volume.
- The headphones are connected to the PHONES jack.
- Check the speaker connections (page 8).
- Check the connection of the optional equipment, if any.
- Turn on the connected equipment.

There is severe hum or noise.

- Move the unit away from the source of noise.
- Connect the unit to a different wall outlet.
- Install a noise filter (commercially available) to the power cord.
- Turn off surrounding electrical equipment.

The timer does not function.

- Check the timer setting and set the correct time (page 16).
- Cancel the Sleep Timer function (page 16).

The remote control does not function.

- Remove the obstacles between the remote control and the unit.
- Move the remote control closer to the unit.
- Point the remote control at the unit's sensor.
- Replace the batteries (R6/size AA).
- Move the unit away from the fluorescent light.

“CHILD LOCK” appears when you press any button on the unit.

- Set the Child Lock function to off (page 18).

Speakers

Sound comes from one channel or unbalanced left and right volume.

- Place the speakers as symmetrically as possible.
- Check that the speakers are connected securely and correctly.
- The source being played back is monaural.

There is no sound from a specific speaker.

- Check that the speaker is connected securely and correctly.

Disc player

Playback does not start.

- Wipe the disc clean (page 24).
- Reload the disc.
- Load the disc that this system can play back (page 19).
- Remove the disc and wipe away the moisture on the disc, then leave the system turned on for a few hours until the moisture evaporates.

The sound skips.

- Wipe the disc clean (page 24).
- Reload the disc.
- Move the unit to a place with no vibration (e.g., on top of a stable stand).
- Move the speakers away from the unit, or place them on separate stands. When you listen to a track with bass sounds at high volume, the speaker vibration may cause the sound to skip.

Playback does not start from the first track.

- Set the play mode to Normal Play (page 9).

The folder name, track name, file name and ID3 tag characters do not appear properly.

- Use a disc that conforms to ISO9660 Level 1/Level 2, or Joliet (expansion format).
- The ID3 tag is not Version 1(1.0/1.1) and Version 2(2.2/2.3).
- The character code that can be displayed by this system are as follows:
 - Upper cases (A to Z)
 - Numbers (0 to 9)
 - Symbols (< > * +, \ _)Other characters appear as “_”.

The disc tray does not open and “LOCKED” appears.

- Contact your Sony dealer or local authorized Sony service facility.

USB device

Transferring results in an error.

- You are using an unsupported USB device. Check the information on the websites about compatible USB devices (page 12).
- The USB device is not formatted correctly. Refer to the operating instructions of the USB device on how to format.
- Turn off the system and remove the USB device. If the USB device has a power switch, turn the USB device off and then on again after removing it from the system. Then perform transferring again.
- If the transferring and erase operations are repeated multiple times, the file structure within the USB device becomes fragmented. Refer to the operating instructions of the USB device on how to deal with this problem.
- The USB device was disconnected or the power was turned off during transferring. Delete the partially-transferred file, and perform transferring again. If this does not fix the problem, the USB device may be broken. Refer to the operating instructions of the USB device on how to deal with this problem.

Audio files or folders on the USB device cannot be erased.

- Check if the USB device is write-protected.
- The USB device was disconnected or the power was turned off during the erase operation. Delete the partially-erased file. If this does not fix the problem, the USB device may be broken. Refer to operating instructions of the USB device on how to deal with this problem.

There is noise, skipping, or distorted sound.

- Turn off the system and reconnect the USB device, then turn on the system.
- The music data itself contains noise, or the sound is distorted. Noise may have entered during the transferring process. Delete the file, and try transferring again.
- The bit rate used when encoding audio files was low. Send audio files with higher bit rate to the USB device.

“READING” is displayed for an extended time, or it takes a long time before playback starts.

- The reading process can take a long time in the following cases.
 - There are many folders or files on the USB device.
 - The file structure is extremely complex.
 - The memory capacity is excessive.
 - The internal memory is fragmented.
- Thus, Sony recommends following guidelines.
- Total folders on USB device: 100 or less
 - Total audio files per folder: 100 or less

“OVER CURRENT” appears.

- A problem has been detected with the level of electrical current from the Ψ port. Turn off the system and remove the USB device from the port. Make sure there is no problem with the USB device.

Erroneous display.

- The data stored in the USB device may have been corrupted, perform the transferring again.
 - The character code that can be displayed by this system are as follows:
 - Upper cases (A to Z)
 - Numbers (0 to 9)
 - Symbols (< > * +, \ _)
- Other characters appear as “_”.

The USB device is not recognized.

- Turn off the system and reconnect the USB device, then turn on the system.
- Check the information on the websites about compatible USB devices (page 12).
- The USB device does not work properly. Refer to the operating instructions of the USB device on how to deal with this problem.

Playback does not start.

- Turn off the system and reconnect the USB device, then turn on the system.
- Check the information on the websites about compatible USB devices (page 12).

Playback does not start from the first file.

- Set the play mode to Normal Play (page 15).

Audio file cannot be played back.

- MP3 files in MP3 PRO format cannot be played back.
- Some AAC files may not be played back correctly.
- The audio file is a multiple track audio file.
- An AAC file which has video stream cannot be played back.
- The data is stored in WMA lossless/ AAC lossless format.
- USB device formatted with file systems other than FAT16 or FAT32 are unsupported.*
- If you use a partitioned USB device, only audio files on the first partition can be played back.
- The system can play back to a depth of 8 folders only.
- Files that are encrypted or protected by passwords and etc. cannot be played back.
- Files with DRM (Digital Rights Management) copyright protection cannot be played back by this system.

* This system supports FAT16 and FAT32, but some USB device may not support all of these FAT. For details, refer to the operating instructions of each USB device or contact the manufacturer.

Tuner

Severe hum or noise, or stations cannot be received. (“TUNED” or “ST” flashes in the display panel.)

- Connect the antenna properly.
- Change antenna location and its orientation to obtain good reception.
- Connect a commercially available external antenna.
- Consult your nearest Sony dealer if the supplied AM antenna has come off from the plastic stand.
- Turn off surrounding electrical equipment.

To reset the system

If the system still does not operate properly, reset the system to factory default settings.

Use the buttons on the unit to perform this operation.

- 1 Unplug and plug the power cord back in.
- 2 Press **I/⏻** to turn on the system.
- 3 Hold down **■**, **OPTIONS** and **I/⏻** at the same time.
“RESET” appears in the display panel.
All user-configured settings, such as preset radio stations, timer, and the clock are reset to factory default setting.

Messages

Disc/Timer

FULL

You tried to program more than 25 steps.

NO DISC

There is no disc on the disc compartment or you have loaded a disc that cannot be played back on this system.

NO STEP

All of the programmed steps have been erased.

NOT USED

You have pressed a button those operation is not allowed or invalid at this time.

OVER

You have reached the end of the disc while pressing **▶▶** during playback or pause.

PUSH SELECT

You tried to set the clock or timer during timer operation.

PUSH STOP

You tried to perform an operation that can be performed only when the playback is stopped.

READING

The system is reading information of the disc. Some buttons are not available.

SET CLOCK

You pressed **CLOCK/TIMER SELECT** before the clock is set.

SET TIMER

You pressed **CLOCK/TIMER SELECT** before the Play Timer is set.

TIME NG

The Play Timer start time and stop time is the same.

Continued 

USB device**DATA ERROR**

You tried to play back a file that is not playable.

DEVICE ERROR

The USB device could not be recognized or an unknown device is connected.

DEVICE FULL

The memory of the USB device is full.

ERASE ERROR

Erase of the audio files or folders failed.

FATAL ERROR

The USB device was removed during transferring or erase operation, and may have been damaged.

FOLDER FULL

The number of folders has reached the maximum.

FULL

You tried to program more than 25 steps.

NoDEVICE

No USB device is connected.

NO MEMORY

The memory selected for playback or transfer has no memory media inserted in the USB device.

NO STEP

All of the programmed steps have been erased.

NO SUPPORT

An unsupported USB device is connected, or the USB device is connected through an USB hub.

NO TRACK

No playable file is loaded in the system.

NOT USED

You tried to perform a specific operation under conditions where that operation is prohibited.

OVER CURRENT

An over current from the Ψ port was detected.

PROTECT

The USB device is write-protected.

PUSH STOP

You tried to perform an operation that can be performed only when the playback is stopped.

READING

The system is reading information of the USB device. Some buttons are not available.

REC ERROR

Transferring did not start, stopped partway, or otherwise could not be performed.

REMOVED

The USB device has been removed.

TRACK FULL

The number of files has reached the maximum.

Precautions

When carrying the unit

Perform the following procedure to protect the disc mechanism.

Use the buttons on the unit to perform this operation.

- 1 Remove the disc.
- 2 Press **I/⏻** to turn off the system and confirm that "STANDBY" stops flashing.
- 3 Unplug the power cord.

Notes on discs

- Before playing, wipe the disc with a cleaning cloth from the center outward to the edge.
- Do not clean discs with solvents, such as benzene, thinner, or commercially available cleaners or anti-static spray intended for vinyl LPs.
- Do not expose discs to direct sunlight or heat sources such as hot air ducts, nor leave it in a car parked in direct sunlight.

On safety

- Completely disconnect the power cord (mains lead) from the wall outlet (mains) if it is not going to be used for an extended period of time. When unplugging the unit, always grip the plug. Never pull the cord itself.
- Should any solid object or liquid get into the system, unplug the system, and have it checked by qualified personnel before operating it again.
- AC power cord must be changed only at the qualified service shop.

On placement

- Do not place the system in an inclined position or in locations that are extremely hot, cold, dusty, dirty, or humid or lacking adequate ventilation, or subject to vibration, direct sunlight or a bright light.
- Be careful when placing the unit or speakers on surfaces that have been specially treated (for example, with wax, oil, polish) as staining or discoloration of the surface may result.
- If the system is brought directly from a cold to a warm location or is placed in a very damp room, moisture may condense on the lens inside the unit, and cause the system to malfunction. In this situation, remove the disc, and leave the system turned on for about an hour until the moisture evaporates.

On heat buildup

- Heat buildup on the unit during operation is normal and is not a cause for alarm.
- Do not touch the cabinet if it has been used continuously at a high volume because the cabinet may have become hot.
- Do not obstruct the ventilation holes.

On the speaker system

This speaker system is not magnetically shielded, and the picture on nearby TV sets may become magnetically distorted. In this situation, turn off the TV, wait 15 to 30 minutes, and turn it back on. If there is no improvement, move the speakers far away from the TV.

Cleaning the cabinet

Clean this system with a soft cloth slightly moistened with a mild detergent solution. Do not use any type of abrasive pad, scouring powder, or solvent, such as thinner, benzine, or alcohol.

Specifications**Amplifier section**

The following are measured at

Mexican model:

AC 120 V – 240 V, 60 Hz

Other models:

AC 120 V – 240 V, 50/60 Hz

MHC-EX990

Front Speaker:

Power output (rated):

100 W + 100 W (at 2 ohms, 1 kHz,
1% THD)

RMS output power (reference):

180 W + 180 W (per channel at
2 ohms, 1 kHz)

Subwoofer:

RMS output power (reference):

360 W (at 4 ohms, 100 Hz)

MHC-EX880

Power output (rated):

140 W + 140 W (at 3 ohms, 1 kHz,
1% THD)

RMS output power (reference):

240 W + 240 W (per channel at
3 ohms, 1 kHz)

MHC-EX660

Power output (rated):

85 W + 85 W (at 4 ohms, 1 kHz,
1% THD)

RMS output power (reference):

150 W + 150 W (per channel at
4 ohms, 1 kHz)

Inputs

DVD/PC IN L/R (phono jacks):

Sensitivity 700 mV, impedance
22 kilohms

Outputs

PHONES (stereo mini jack):

accepts headphones with an impedance
of 8 ohms or more

Continued 

USB section

Supported bit rate:

MP3 (MPEG 1 Audio Layer-3):

32 kbps – 320 kbps, VBR

WMA: 48 kbps – 192 kbps

AAC: 48 kbps – 320 kbps

Sampling frequencies:

MP3 (MPEG 1 Audio Layer-3):

32/44.1/48 kHz

WMA: 44.1 kHz

AAC: 44.1 kHz

ψ (USB) port:

Maximum current: 500 mA

CD player section

System

Compact disc and digital audio system

Laser Diode Properties

Emission Duration: Continuous

Laser Output*: Less than 44.6 μW

* This output is the value measurement at a distance of 200 mm from the objective lens surface on the Optical Pick-up Block with 7 mm aperture.

Frequency response: 20 Hz – 20 kHz

Signal-to-noise ratio: More than 90 dB

Dynamic range: More than 88 dB

Tuner section

FM stereo, FM/AM superheterodyne tuner

Antenna:

FM lead antenna

AM loop antenna

FM tuner section

Tuning range:

87.5 MHz – 108.0 MHz (50 kHz step)

AM tuner section

Tuning range

Latin American models:

530 kHz – 1,710 kHz (10 kHz step)

531 kHz – 1,710 kHz (9 kHz step)

Russian models:

531 kHz – 1,602 kHz (9 kHz step)

Other models:

531 kHz – 1,602 kHz (9 kHz step)

530 kHz – 1,610 kHz (10 kHz step)

Speakers

Front Speaker

SS-EX990Z for MHC-EX990

SS-EX880Z for MHC-EX880

SS-EX660Z for MHC-EX660

Speaker system:

2-way 2-driver speaker system, Bass reflex

Speaker unit:

Tweeter: 40 mm, horn type

Woofer:

(SS-EX990Z/SS-EX880Z) 180 mm, cone type

(SS-EX660Z) 160 mm, cone type

Rated impedance:

SS-EX990Z: 2 ohms

SS-EX880Z: 3 ohms

SS-EX660Z: 4 ohms

Dimensions (w/h/d) (Approx.)

SS-EX990Z/SS-EX880Z: 250 mm × 343 mm × 260 mm

SS-EX660Z: 230 mm × 308 mm × 230 mm

Mass (Approx.)

SS-EX990Z/SS-EX880Z: 4.0 kg

SS-EX660Z: 3.0 kg

Quantity: 2 pieces

Subwoofer

SS-WG990Z for MHC-EX990

Speaker system:

Subwoofer system, Bass reflex

Speaker unit:

Subwoofer: 200 mm, cone type

Rated impedance: 4 ohms

Dimensions (w/h/d) (Approx.)

275 mm × 308 mm × 290 mm

Mass (Approx.)

5.0 kg

Quantity: 1 piece

General

Power requirements

Mexican model:

AC 120 V – 240 V, 60 Hz

Other models:

AC 120 V – 240 V, 50/60 Hz

Power consumption

MHC-EX990: 115 W

MHC-EX880: 85 W

MHC-EX660: 65 W

Dimensions (w/h/d) (excl. speakers)

(Approx.)

MHC-EX990/EX880: 240 mm ×

315 mm × 382 mm

MHC-EX660: 240 mm × 315 mm ×

347.8 mm

Mass (excl. speakers) (Approx.)

MHC-EX990: 4.25 kg

MHC-EX880: 4.18 kg

MHC-EX660: 3.40 kg

Quantity of the main unit: 1 piece

Supplied accessories: Remote control (1),

R6 (Size AA) batteries (2), FM lead/

AM loop antenna (1)

Design and specifications are subject to
change without notice.

Standby power consumption: 0.5 W

<http://www.sony.net/>

COMPACT
disc
DIGITAL AUDIO



©2012 Sony Corporation Printed in China



* 4 4 2 2 2 5 1 1 1 * (1)