

Personal Audio System

Sistema de audio personal

Reference Guide

Guía de referencia



SRS-XB2

©2016 Sony Corporation
Printed in China
<http://www.sony.net/>



* 4 5 8 7 0 4 5 7 1 * (1)

English

Personal Audio System

Before operating the system, please read this guide thoroughly and retain it for future reference.

WARNING

To reduce the risk of fire or electric shock, do not expose the USB AC adaptor to rain or moisture.

To reduce the risk of fire, do not cover the ventilation opening of the appliance with newspapers, tablecloths, curtains, etc.
Do not expose the appliance to naked flame sources (for example, lighted candles).
To reduce the risk of fire or electric shock, do not expose the USB AC adaptor to dripping or splashing, and do not place objects filled with liquids, such as vases, on the USB AC adaptor.
Do not install the appliance in a confined space, such as a bookcase or built-in cabinet.
Do not expose the batteries (battery pack or batteries installed) to excessive heat such as sunshine, fire or the like for a long time.
As the main plug of the USB AC adaptor is used to disconnect the USB AC adaptor from the mains, connect it to an easily accessible AC outlet. Should you notice an abnormality in it, disconnect it from AC outlet immediately.
The unit is not disconnected from the AC power source (mains) as long as it is connected to the wall outlet, even if the unit itself has been turned off.

If your skin touches the USB AC adaptor or this product for a long time when the power is on, it may cause a low temperature injury.

Precautions

Note when using with a mobile phone

- For details on operation of your mobile phone when receiving a telephone call while transmitting the sound using the BLUETOOTH connection, refer to the operating instructions supplied with the mobile phone.

On safety

- The nameplate and important information concerning safety are located on the bottom exterior of the main unit and on the surface of the USB AC adaptor.
- Before operating the system, be sure that the operating voltage of the system is identical with that of your local power supply.

Where purchased	Operating voltage
All countries/regions	100 V - 240 V AC, 50 Hz/60 Hz

Notes on the USB AC adaptor

- When connecting or disconnecting the USB AC adaptor, turn off the system beforehand. Otherwise, it may cause malfunction.
- Use only the supplied USB AC adaptor and micro-USB cable. To avoid damaging the system, do not use any other USB AC adaptor.

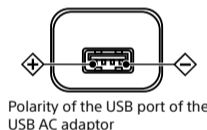

- Plug the USB AC adaptor into a nearby wall outlet (mains). In the case of a problem, unplug it from the wall outlet (mains) immediately.
- Do not install the USB AC adaptor in a confined space, such as a bookcase or built-in cabinet.
- To reduce the risk of fire or electric shock, do not expose the USB AC adaptor to dripping or splashing, and do not place objects filled with liquids, such as vases, on the USB AC adaptor.

On placement

- Do not set the speaker in an inclined position.
- Do not leave the system in a location near heat sources, or in a place subject to direct sunlight, excessive dust, moisture, rain or mechanical shock.

On operation

- Do not insert any small objects, etc., into the jacks or ventilation hole on the rear of the system. The system may short out or malfunction.

On cleaning

- Do not use alcohol, benzene, or thinner to clean the cabinet.

Others

- Two units are required when using the Speaker Add function. Only the SBC codec is supported while using the Speaker Add function.
- If you have any questions or problems concerning this system that are not covered in this manual, please consult your nearest Sony dealer.

On Copyrights

- LDAC™ and LDAC logo are trademarks of Sony Corporation.
- The BLUETOOTH® word mark and logos are owned by the Bluetooth SIG, Inc. and any use of such marks by Sony Corporation is under license.
- The N Mark is a trademark or registered trademark of NFC Forum, Inc. in the United States and in other countries.
- Other trademarks and trade names are those of their respective owners.

Notes on water resistant feature (Read before using the system)

Water resistant performance of the system

This system has a water resistant specification*1,*2 of IPX5*3 as specified in "Degrees of protection against ingress of water" of the IEC60529 "Ingress Protection Rating (IP Code)." However, this system is not completely water-tight.

Do not drop the system into hot water in a bathtub or purposely use it in water. Depending on usage, water entering the system may cause fire, electric shock or malfunction.
Use the system with full understanding of the following.

Liquids that the water resistant performance specifications apply to

Applicable :	fresh water, tap water, sweat
Not applicable :	liquids other than the above (soapy water, water with detergent or bath agents, shampoo, hot spring water, hot water, pool water, seawater, etc.)

*1 Requires that the cap is fastened securely.

*2 The supplied accessories are not water resistant.

*3 IPX5 (Degree of protection against jets of water): The system has been tested and found to remain functional after exposure to direct jet streams of water using a nozzle of 6.3 mm (about 1/4 in) internal diameter from any direction where approximately 12.5 L/ min of water is applied for a period of more than 3 minutes from a distance of about 3 meters (about 10 ft).

The water resistant performance of the system is based on our measurements under the conditions herein described. Note that malfunctions as a result of water immersion caused by misuse by the customer are not covered by the warranty.

To avoid the deterioration of the water resistant performance

Check the following and use the system correctly.

- Do not use or leave the system in an extremely hot or cold environment (temperature outside the

range of 5 °C - 35 °C (41 °F - 95 °F)). If the system is used or left in outside the above range, the system may automatically stop to protect internal circuitry.

- Be careful not to drop the system or subject it to mechanical shock. Deformation or damage may cause deterioration of the water resistant performance.
- Do not use the system in a location where large amount of water or hot water may splash on it. The system does not have a design that is resistant to water pressure. Use of the system in the above location may cause a malfunction.
- Do not pour high-temperature water or blow hot air from a hair dryer or any other appliance on the system directly. Also, never use the system in high temperature locations such as in saunas or near a stove.
- Handle the cap with care. The cap plays a very important role in maintenance of the water resistant performance. When using the system, make sure that the cap is closed completely. When closing the cap, be careful not to allow foreign objects inside. If the cap is not closed completely the water resistant performance may deteriorate and may cause a malfunction of the system as a result of water entering the system.

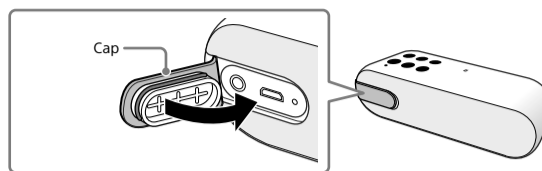

How to care for the system when wet

If the system gets wet, first remove the water from the system, and then wipe off the moisture on the system using a soft, dry cloth. Especially in cold regions, leaving moisture on its surface may cause the system to freeze and malfunction. Be sure to wipe off the moisture after using the system.

Put the system on towel or dry cloth. Then leave it at room temperature and dry the system until no moisture remains.

Specifications

Speaker section

Speaker system Approx. 42 mm dia. x 2
Enclosure type Passive radiator model

BLUETOOTH

Communication System

BLUETOOTH Specification version 3.0
Output BLUETOOTH Specification Power Class 2
Maximum communication range Line of sight approx. 10 m*1
Frequency band 2.4 GHz band (2.4000 GHz - 2.4835 GHz)
Modulation method FHSS
Compatible BLUETOOTH Profiles*2
A2DP (Advanced Audio Distribution Profile)
AVRCP (Audio Video Remote Control Profile)
HSP (Headset Profile)
HFP (Hands-free Profile)
Supported Codec*3 SBC*4, AAC*5, LDAC*6
Transmission range (A2DP)
20 Hz - 20,000 Hz (Sampling frequency 44.1 kHz)

*1 The actual range will vary depending on factors such as obstacles between devices, magnetic fields around a microwave oven, static electricity, reception sensitivity, aerial's performance, operating system, software application, etc.

*2 BLUETOOTH standard profiles indicate the purpose of BLUETOOTH communication between devices.

*3 Codec: Audio signal compression and conversion format

*4 Subband Codec

*5 Advanced Audio Coding

*6 LDAC is an audio coding technology developed by Sony that enables the transmission of High-Resolution (Hi-Res) Audio content, even over a BLUETOOTH connection. Unlike other BLUETOOTH compatible coding technologies such as SBC, it operates without any down-conversion of the Hi-Res Audio content*7, and allows approximately three times more data*8 than those other technologies to be transmitted over a BLUETOOTH wireless network with unprecedented sound quality, by means of efficient coding and optimized packetization.

*7 Excluding DSD format contents.

*8 In comparison with SBC (Subband Coding) when the bitrate of 990 kbps (96/48 kHz) or 909 kbps (88.2/44.1 kHz) is selected.

Microphone

Type Electret condenser
Directional characteristic Omni directional
Effective frequency range 100 Hz - 7,000 Hz

General

Input AUDIO IN jack (ø 3.5 mm stereo mini jack)
Power DC 5 V (using the supplied USB AC adaptor connected to AC 100 V - 240 V, 50 Hz/60 Hz power supply) or, using built-in lithium-ion battery
Usage life of lithium-ion battery (using the BLUETOOTH connection) Approx. 12 hours*9
Dimensions (including projecting parts and controls) Approx. 191 mm x 62 mm x 65 mm (w/h/d)
Mass Approx. 480 g including battery
Supplied accessories USB AC adaptor (1)
Plug (2)*10
Micro-USB cable (1)
Operating Instructions (1)
Reference Guide (this document) (1)

*9 When the specified music source is used and the volume level of the unit is set to 10. If the volume level of the unit is set to maximum, the usage life will be approx. 3 hours.

Time may vary, depending on the temperature or conditions of use.

*10 Attach a plug to the USB AC adaptor before use. If multiple plugs are included, use one which is appropriate to your country/region. Be sure to completely insert the plug into the USB AC adaptor until it clicks.

Design and specifications are subject to change without notice.

