

# IC Recorder

## Operating Instructions

**Owner's Record**  
The model number is located at the rear and the serial number is located inside the battery compartment. Record the serial number in the space provided below. Refer to these numbers whenever you call upon your Sony dealer regarding this product.

Model No. ICD-P17 \_\_\_\_\_ Serial No. \_\_\_\_\_

# IC RECORDER ICD-P17

Sony Corporation ©2003 Printed in Japan

Printed on 100% recycled paper using VOC (Volatile Organic Compound)-free vegetable oil based ink.  
<http://www.sony.net/>

### Information

IN NO EVENT SHALL SELLER BE LIABLE FOR ANY DIRECT, INCIDENTAL OR CONSEQUENTIAL DAMAGES OF ANY NATURE, OR LOSSES OR EXPENSES RESULTING FROM ANY DEFECTIVE PRODUCT OR THE USE OF ANY PRODUCT.

### For the customers in the U.S.A.

#### INFORMATION

This equipment has been tested and found to comply with the limits for a Class B digital device, pursuant to Part 15 of the FCC Rules. These limits are designed to provide reasonable protection against harmful interference in a residential installation. This equipment generates, uses, and can radiate radio frequency energy and, if not installed and used in accordance with the instructions, may cause harmful interference to radio communications. However, there is no guarantee that interference will not occur in a particular installation. If this equipment does cause harmful interference to radio or television reception, which can be determined by turning the equipment off and on, the user is encouraged to try to correct the interference by one or more of the following measures:

- Reorient or relocate the receiving antenna.
- Increase the separation between the equipment and the receiver.
- Connect the equipment into an outlet on a circuit different from that to which the receiver is connected.
- Consult the dealer or an experienced radio/TV technician for help.

You are cautioned that any changes or modifications not expressly approved in this manual could void your authority to operate this equipment.

If you have any questions about this product, you may call: Sony Direct Response Center 1-(800)-222-7669 or write to: Sony Direct Response Center 12451 Gateway Blvd. Fort Myers, FL 33913

#### Declaration of Conformity

Trade Name: SONY  
Model No.: ICD-P17  
Responsible Party: Sony Electronics Inc.  
Address: 680 Kinderkamack Road, Oradell, NJ, 07649 USA  
Telephone No.: 201-930-6972

This device complies with Part 15 of the FCC Rules. Operation is subject to the following two conditions: (1) This device may not cause harmful interference, and (2) this device must accept any interference received, including interference that may cause undesired operation.

### Precautions

#### On power

- Operate the unit only on 3 V DC. Use two LR03 (size AAA) alkaline batteries.

#### On safety

- Do not operate the unit while driving, cycling or operating any motorized vehicle.

#### On handling

- Do not leave the unit in a location near heat sources, or in a place subject to direct sunlight, excessive dust or mechanical shock.
- Should any solid object or liquid fall into the unit, remove the batteries and have the unit checked by qualified personnel before operating it any further.

#### On noise

- Noise may be heard when the unit is placed near an AC power source, a fluorescent lamp or a mobile phone during recording or playback.
- Noise may be recorded when an object, such as your finger, etc., rubs or scratches the unit during recording.

#### On maintenance

- To clean the exterior, use a soft cloth slightly moistened in water. Do not use alcohol, benzine or thinner.

Keep personal credit cards using magnetic coding or spring-wound watches, etc., away from the unit to prevent possible damage from the magnet used in the speaker.

If you have any questions or problems concerning your unit, please consult your nearest Sony dealer.

#### Backup recommendations

To avoid potential risk of data loss caused by accidental operation or malfunction of the IC recorder, we recommend that you save a backup copy of your recorded messages on a tape recorder or to a computer, etc.

### ►Getting started

## Step 1: Installing the Batteries

### 1 Slide and lift the battery compartment lid.

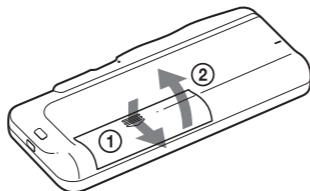

#### Replacing the batteries

The battery indicator on the display window shows the battery condition. When [ ] flashes, replace the batteries with new ones. When [ ] flashes, the batteries are exhausted and the unit will stop operation.

#### Battery life\*

With continuous use, approx. 10 hours recording/8 hours playback is possible.  
\* Using Sony alkaline batteries LR03 (size AAA)  
\* When playing back through the internal speaker with VOL control at around 4  
The battery life may shorten depending on the operation of the unit.

#### Notes

- Do not use manganese batteries for this unit.
- When you replace the batteries, insert the new ones within 3 minutes after you removed the exhausted ones. Otherwise, the display may show the clock setting display or incorrect date and time when you reinsert the batteries. In this case, set the date and time again.
- The recorded messages and alarm setting, however, will remain.
- When replacing the batteries, be sure to replace both batteries with new ones.
- Do not charge dry batteries.
- When you are not going to use the unit for a long time, remove the batteries to prevent damage from battery leakage and corrosion.

### 2 Insert two LR03 (size AAA) alkaline batteries with correct polarity, and close the lid.

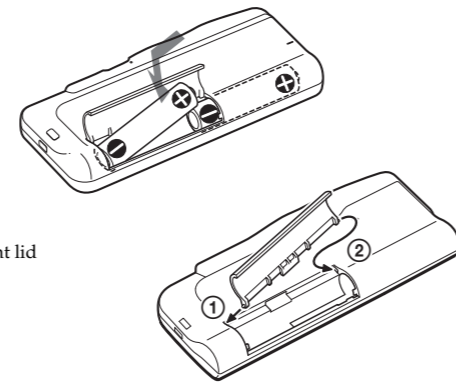

If the battery compartment lid is accidentally detached, attach it as illustrated.

Clock setting display appears when you insert batteries for the first time, or when you insert batteries after the unit has been without batteries for a certain period of time. Please refer to Steps 2 to 3 in "Step 2: Setting the Clock" to set the date and time.

### ►Basic Operations

## Recording Messages

You can record up to 99 messages in each of the five folders (A, B, C, D, and E). Since a newly recorded message is automatically added behind the last recorded message, you can start recording quickly without searching for the end of the last recording.

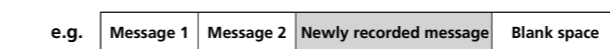

#### Note

Before making a long recording, be sure to insert new batteries and check the battery indicator.

### 1 Select the folder.



### 2 Start recording.

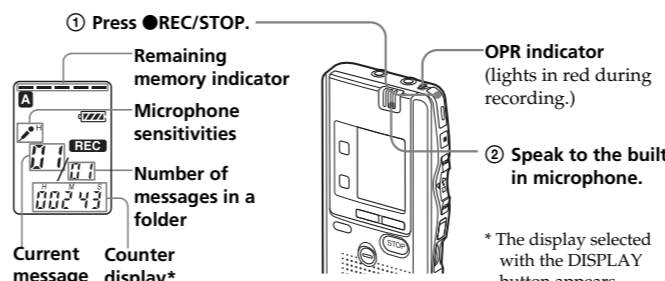

You do not need to keep pressing REC/STOP while recording.

### 3 Stop recording.

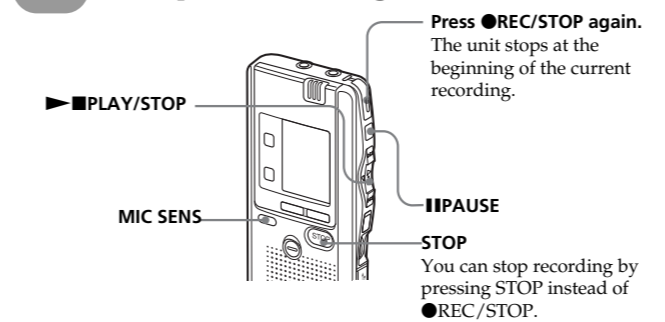

If you do not change the folder after you stop recording, the next time you record you will record in the same folder.

To	Do this
pause recording*	Press <b>PAUSE</b> . During recording pause, the OPR indicator flashes in red and "PAUSE" flashes in the display window.
release pause and resume recording	Press <b>PAUSE</b> or <b>REC/STOP</b> . Recording resumes from that point. (To stop recording after pausing recording, press <b>STOP</b> .)
listen to the current recording	Press <b>REC/STOP</b> or <b>STOP</b> to stop recording, then press <b>PLAY/STOP</b> .
review the current recording instantly	Press <b>PLAY/STOP</b> during recording.
select the microphone sensitivity	You can select the microphone sensitivity to display the following by pressing <b>MIC SENS</b> . HIGH: To record at meeting or in a quiet and/or spacious place. LOW: To record for dictation or in a noisy place.

\* About one hour after you pause recording, recording pause is automatically released and the unit goes into the stop mode.

#### Note on recording

Noise may be recorded if an object, such as your finger, etc., accidentally rubs or scratches the unit during recording.

#### Maximum recording time

You can record for up to 276 minutes. You can check the remaining amount of recording time by selecting the remaining recording time display mode.

#### Notes

- Due to the limitation of the IC recording system, this unit records in the minimum recording unit of approx. 9 seconds, therefore the following symptoms may occur:  
• When a message is shorter than the minimum recording unit, it is still counted as approx. 9 seconds so the remaining recording time will decrease by more than the actual length of the message.
- When the message is longer than the minimum recording unit, the remaining recording time will decrease by more than the actual length of the message if it cannot be divided by the minimum recording unit without a remainder.
- The sum of the number on the counter (elapsed recording time) and the remaining recording time may be less than the unit's maximum recording time.

#### Remaining memory indication

During recording, the remaining memory indicator decreases one by one.



When the remaining time of recording reaches 5 minutes, the last one of the indication flashes. When the remaining time of recording reaches 1 minute, the selected display mode and "REMAIN" will flash one after the other in the display window. When the memory is full, recording automatically stops and "FULL" will flash in the display window with an alarm sound. To continue recording, first erase some of the messages.

#### Notes

- If you press **REC/STOP** when the memory is full, "FULL" will flash with an alarm sound. Erase some of the messages before you start recording again.
- If you press **REC/STOP** after you have recorded 99 messages, "FULL" will flash with an alarm sound. Select another folder or erase some of the messages.

## Playing Back Messages

When playing back a previously recorded message, start from Step 1. When playing back a message you have just finished recording, start from Step 3.

### 1 Select the folder.

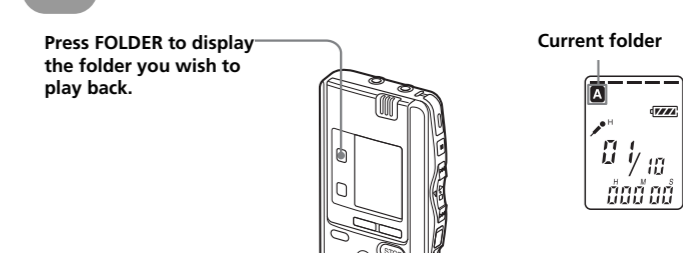

### 2 Select the message number.

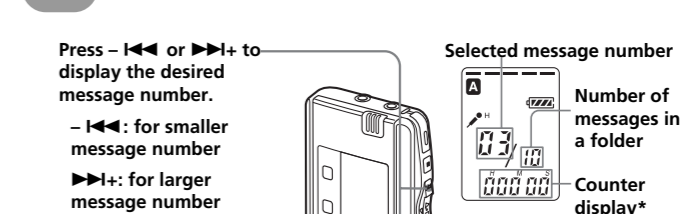

### 3 Start playback.

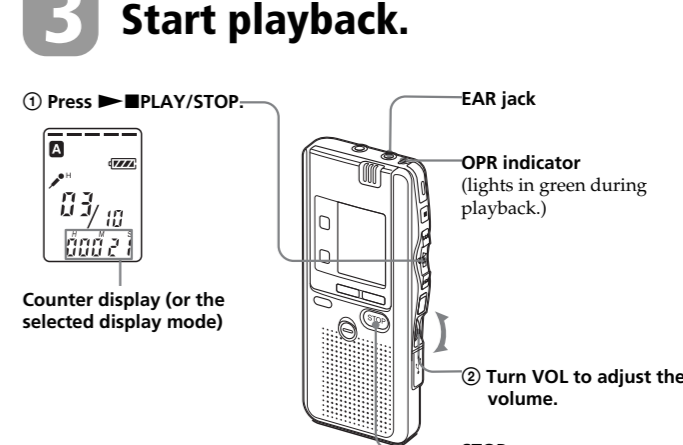

After playing back one message, the unit stops at the beginning of the next message. When the continuous play function is set to "ON" (see the reverse side), the unit stops after playing all messages in a folder. When the last message on a folder has been played back, the unit stops at the beginning of the last message.

#### For private listening

Connect an earphone or headphones (not supplied) to the EAR jack. The built-in speaker will be automatically disconnected. If you plug in headphones, you will get output from the left channel only. If noise is heard, wipe the headphones plug.

#### Other operations

To	Do this
stop at the beginning of the current message	Press <b>STOP</b> .
stop at the current position (Playback Pause function)*	Press <b>PLAY/STOP</b> . To resume playback from that point, press <b>PLAY/STOP</b> again.
go back to the beginning of the current message	Press <b>left arrow</b> once.
skip to the next message	Press <b>right arrow</b> once.
go back to previous messages/skip to succeeding messages	Press <b>left arrow</b> or <b>right arrow</b> repeatedly. (During stop mode, keep the button pressed to skip the messages continuously.)

\* You can also pause playback by pressing **PAUSE** instead of **PLAY/STOP**. The OPR indicator will flash in green. After about one hour, the unit goes into the stop mode at the current position.

#### Playing back a message repeatedly

**Repeat Play**  
During playback, press **PLAY/STOP** for more than one second. "C" will be displayed and the selected message will be played back repeatedly.  
To resume normal playback, press **PLAY/STOP** again. To stop playback, press **STOP**.

#### Playing the beginning of each message

**Scanning Play**  
During stop mode, press **PLAY/STOP** for more than one second. "SCAN" will be displayed in the display window and the first 5 seconds of each message in the selected folder will be played back. When you find the desired message, press **PLAY/STOP**. The message will be played back until the end.

#### Playing back all messages in a folder continuously

**Continuous Play**  
You can select the continuous play mode with the CONT in the menu. When you set CONT to ON, you can play back all messages in a folder continuously.

#### Searching forward/backward during playback (Cue/Review)

To search forward, keep **right arrow** pressed during playback and release the button at the point you wish to resume playback. To search backward, keep **left arrow** pressed during playback and release the button at the point you wish to resume playback. If you keep **right arrow** or **left arrow** pressed for more than 10 seconds, the unit starts to search at higher speed. For the first 10 seconds of cue/review, fast playback sound can be heard. When searching at a higher speed, playback sound will not be heard. During cue/review, the counter will be displayed, regardless of the display mode setting.

#### Tip

When fast playback is done to the end of the last message, "END" flashes 3 times. (You cannot hear the playback sound.) If you keep **left arrow** pressed while "END" is flashing, the messages are played back rapidly, and normal playback will start at the point you release the button. When "END" stops flashing and the OPR indicator goes off, the unit will stop at the beginning of the last message. If the last message is long and you wish to start playback at a later part of the message, keep **right arrow** pressed to play back the message to the end and then press **left arrow** while "END" is flashing to go back to the desired point. (For messages other than the last one, go to the beginning of the next message and play backward to the desired point.)

## Step 2: Setting the Clock

Clock setting display appears when you insert batteries for the first time, or when you insert battery after the unit has been without battery for a certain period of time. In this case, proceed from step 2.

### 1 Display the clock setting display.

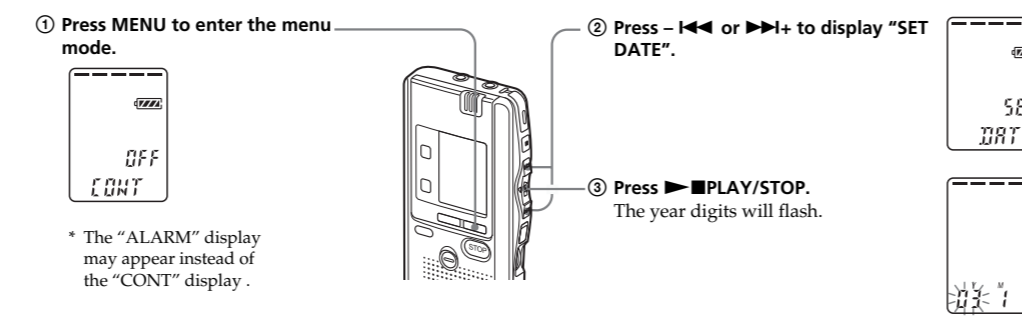

The year digits will flash.

### 2 Set the date.

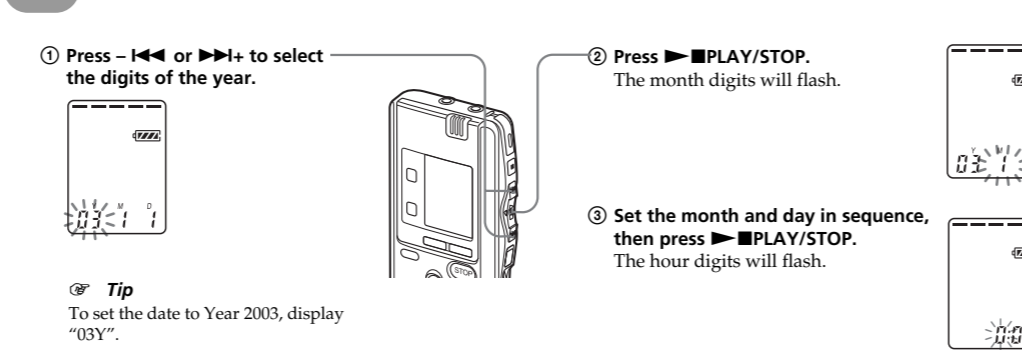

*Tip*  
To set the date to Year 2003, display "03Y".

### 3 Set the time.

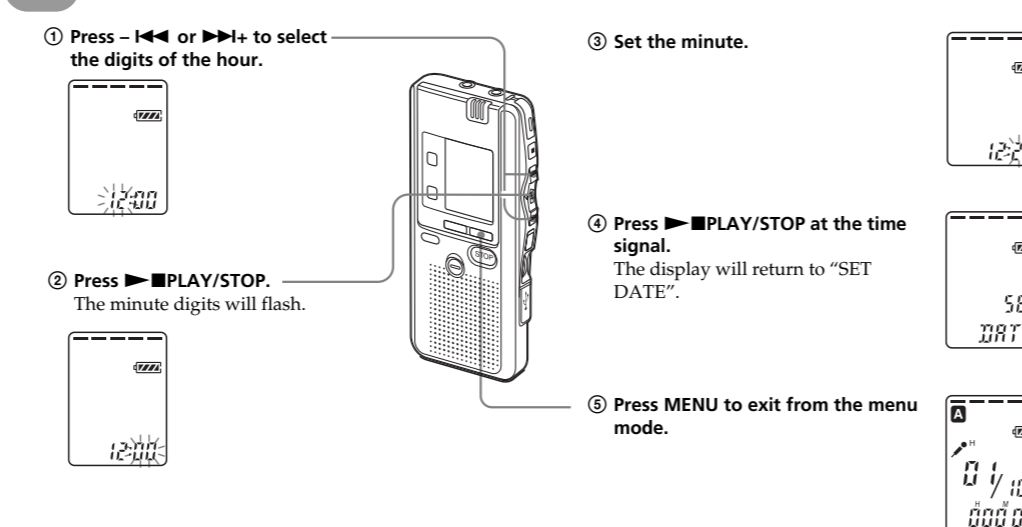

*Tip*  
This unit does not have a power on/off switch. The display is shown at all times.

