

"WALKMAN" is a registered trademark of Sony Corporation to represent Headphone Stereo products.

WALKMAN is a registered trademark of Sony Corporation.

The validity of the CE marking is restricted to only those countries where it is legally enforced, mainly in the countries EEA (European Economic Area).

SONY WM-FX290

Tested to Comply With FCC Standards FOR HOME OR OFFICE USE

# Radio Cassette Player

## Operating Instructions



### WM-FX290

© 2004 Sony Corporation Printed in China

**A**

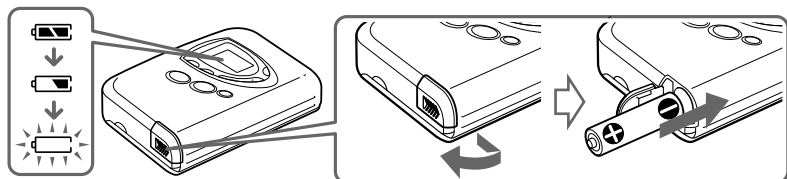

**B**

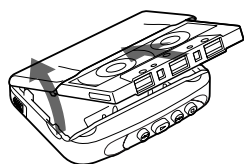

**C**

FM

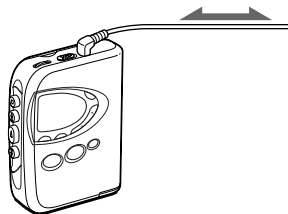

AM

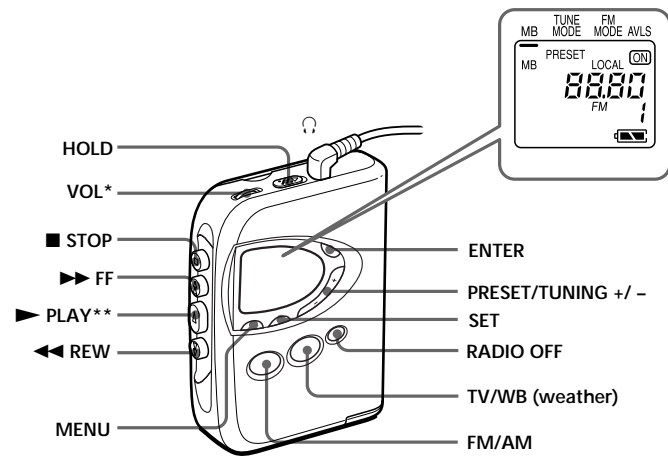
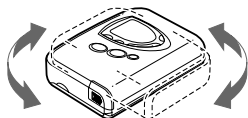

\* There is a tactile dot beside VOL on the main unit to show the direction to turn up the volume.  
\*\* The button has a tactile dot.

### Specifications

- Frequency range**  
TV: 2 - 13 ch  
FM: 87.5 - 108 MHz  
WB (Weather): 1 - 7 ch  
AM: 530 - 1 710 kHz
- Output**  
Headphones (♻️) jack  
Load impedance 8 - 300 Ω
- Power requirements**  
1.5V DC, battery size AA (R6) x 1
- Dimensions (w/h/d)**  
Approx. 83.6 x 112.0 x 28.3 mm (3 3/8 x 4 1/2 x 1 1/8 inches) excl. projecting parts and controls
- Mass**  
Approx. 130 g (4.6 oz) (main unit only)
- Supplied accessories**  
Stereo headphones or Stereo earphones (1)  
Carrying case with belt clip(1)

Design and specifications are subject to change without notice.

### Battery life\* (approximate hours)

	Sony alkaline LR6 (SG)**	Sony R6P (SR)
Tape playback	35	9
Radio reception	40	14

\* Measured value by the standard of JEITA (Japan Electronics and Information Technology Industries Association). (Using a Sony HF series cassette tape)  
\*\*When using a Sony LR6 (SG) alkaline dry battery (produced in Japan).

**Note**  
The battery life may be shorter depending on the operating condition, the surrounding temperature and battery type.

### For customers in the United States Owner's Record

The model number is located on the bottom and the serial number is located inside the cassette holder. Record these numbers in the space provided below. Refer to them whenever you call upon your Sony dealer regarding this product.  
Model No. WM-FX290  
Serial No. \_\_\_\_\_

### Product registration

Please register this product on line at [www.sony.com/productregistration](http://www.sony.com/productregistration).  
<<http://www.sony.com/productregistration>>

Proper registration will enable us to send you periodic mailings about new products, services, and other important announcements. Registering your product will also allow us to contact you in the unlikely event that the product needs adjustment or modification. Thank you.

### INFORMATION

You are cautioned that any changes or modifications not expressly approved in this manual could void your authority to operate this equipment.

If you have any questions about this product, you may call:  
Sony Direct Response Center 1-(800)-222-7669  
or write to: Sony Direct Response Center 12451 Gateway Blvd. Fort Myers, FL 33913

### Declaration of Conformity

Trade Name: SONY  
Model No.: WM-FX290  
Responsible Party: Sony Electronics Inc.  
Address: 680 Kinderkamack Road, Oradell, NJ 07649 USA  
Telephone No.: 201-930-6972

This device complies with Part 15 of the FCC Rules. Operation is subject to the following two conditions:  
(1) This device may not cause harmful interference, and (2) this device must accept any interference received, including interference that may cause undesired operation.

## Preparations

### To Insert Battery **A**

- Slide open the battery compartment lid, and insert one size AA (R6) dry battery with correct polarity.

Replace the battery with new one when " " flashes in the display.

## Playing a Tape

- Insert a cassette. **B**
- Press PLAY.  
Adjust the volume with VOL.

To	Press
Stop playback	STOP
Wind rapidly*	FF or  REW

\* If you leave the unit after the tape has been wound or rewound, the battery will be consumed rapidly. Be sure to press STOP.

### Note

Do not open the cassette holder while the tape is running.

## Using Other Functions

### Locking the Controls

Set the HOLD switch in the direction of the mark to lock the controls.

The HOLD function only locks the radio operation buttons, MENU, SET, PRESET/TUNING + or - and ENTER.

### Emphasizing Bass Sound

Press MENU repeatedly to set " " (the cursor) to MB (mega bass) in the display. Then, press SET to turn MB on. With each press, the indications change as follows.

MB (mega bass) : emphasizes bass sound  
No message: off (normal)

### Notes

- If the sound is distorted with the mode "MB", turn down the volume or select normal mode.
- Bass emphasis may not show great effect if the volume is turned up too high.

### Protecting Your Hearing—AVLS (Automatic Volume Limiter System)

Press MENU repeatedly to set the cursor to AVLS in the display. Then press SET to show " ". The maximum volume is kept down to protect your ears.

## Listening to the Radio

- If the HOLD function is turned on, set the HOLD switch in the opposite direction of the mark to unlock the controls. Make sure that the tape has stopped completely.
- Press FM/AM or TV/WB (weather band) repeatedly to select the desired band and to turn on the radio.
- For manual tuning:
  - Press MENU repeatedly to set the cursor in the display to TUNE MODE and press SET to choose "MANUAL".
  - Press PRESET/TUNING + or - repeatedly to tune in to the desired station.  
Hold down PRESET/TUNING + or - for a few seconds to scan for stations.

### For preset tuning:

- Press MENU repeatedly to set the cursor in the display to TUNE MODE and press SET to choose "PRESET".
- Press PRESET/TUNING + or - repeatedly to recall the desired preset station.  
To use preset tuning, preset the station first (see "Presetting Radio Stations").

### To turn off the radio

Press RADIO OFF.

### To improve broadcast reception **C**

- For TV/WB/FM: Extend the headphones/earphones cord (antenna). If the reception is still not good, press MENU repeatedly to set the cursor in the display to FM MODE. Then press SET to switch between "LOCAL" and none (DX) for best reception.
- For AM: Reorient the unit itself.

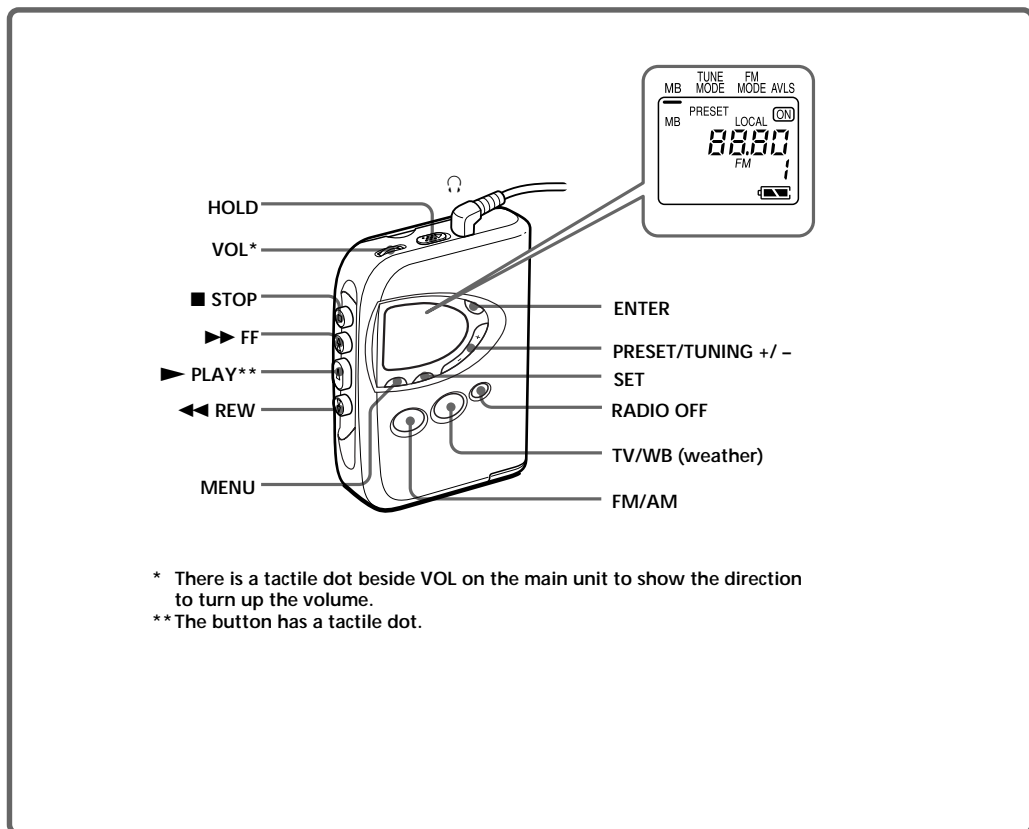

## Presetting Radio Stations

You can preset up to 40 stations (7 for TV, 4 for WB, 24 for FM and 5 for AM).

### Presetting Automatically Scanned Stations

- 1 Press FM/AM or TV/WB repeatedly to select the desired band and to turn on the radio.

- 2 Press and hold ENTER for more than 3 seconds.

Preset number 1 will flash in the display and the Walkman starts scanning the stations from the lower frequencies and stops for about 5 seconds when a station is received.

- 3 If you wish to preset the currently received station, press ENTER while the preset number is flashing.

The received station is preset on preset number 1 and the unit starts scanning for the next receivable station.

- 4 Repeat Step 3 until all receivable stations are preset.

### To stop scanning

Press RADIO OFF. The radio is turned off at the same time.

#### Notes

- If stations are already stored, the newly preset stations replace the old ones when the above procedure is completed.
- If stations cannot be preset automatically, preset them manually.

### Presetting Stations Manually

- 1 Press FM/AM or TV/WB repeatedly to select the desired band and to turn on the radio.

- 2 Press ENTER.

The frequency digits will flash in the display.

- 3 While the frequency digits are flashing, tune in to a station you wish to store using PRESET/TUNING + or - and press ENTER.

The preset number will flash in the display.

- 4 While the preset number is flashing, select the preset number you want using PRESET/TUNING + or - and press ENTER.

#### Notes

- If you cannot complete step 3 or 4 while the indicators are flashing, repeat from step 2.
- If a station is already stored, the new station replaces the old one.

### Playing the Preset Radio Stations

- 1 Press FM/AM or TV/WB repeatedly to select the desired band and to turn on the radio.

- 2 Press MENU repeatedly to set the cursor in the display to TUNE MODE. Then press SET to display "PRESET".

- 3 Press PRESET/TUNING + or -.

### To cancel a stored station

- 1 Follow the procedure above and in step 3, select the preset number you want to cancel and then press ENTER. The frequency digits will flash in the display.

- 2 Press and hold PRESET/TUNING + or -. The frequency digit starts running up or down. Keep holding down the button until "----" is displayed.

- 3 Press ENTER while "----" is flashing. A preset number will flash in the display.

- 4 Press ENTER to cancel the stored station.

## Scanning the Preset Radio Stations

### — DAPS (Digital Auto Preset Scanning)

- 1 Press FM/AM or TV/WB repeatedly to select the desired band and to turn on the radio.

- 2 Press and hold FM/AM or TV/WB pressed in step 1 for 2 seconds or more.

The preset stations of the selected band will be played for about 5 seconds each. (During DAPS the indicators in the display flash.)

- 3 Press FM/AM or TV/WB again to select the station while the desired preset station is being played.

#### Notes

- If there are no stations stored, the DAPS function does not work.
- Until a station is selected in step 3, the DAPS function turned on in step 2 will continue.
- In step 2 or 3, if you select a band which you did not select in step 1 by pressing FM/AM or TV/WB, the newly selected band will be played normally.

## Precautions

### On batteries

- Do not carry dry batteries with coins or other metallic objects. It can generate heat if the positive and negative terminals of the batteries are accidentally contacted by a metallic object.
- When you are not going to use your Walkman for a long time, remove the battery to prevent damage from battery leakage and corrosion.

### On handling

- Do not leave the unit in a location near heat sources, or in a place subject to direct sunlight, excessive dust or sand, moisture, rain, mechanical shock, or in a car with its windows closed.
- We do not recommend the use of tape longer than 90 minutes. They are very thin and tend to be stretched easily. This may cause malfunction of the unit or sound deterioration.
- The LCD display may become hard to see or slow down when using the unit at high temperatures (above 40°C/104°F) or at low temperatures (below 0°C/32°F). At room temperature, the display will return to its normal operating condition.
- If the unit has not been used for a long time, set it in the playback mode to warm it up for a few minutes before you start using it again.

### On headphones/earphones

#### Road safety

Do not use headphones/earphones while driving, cycling, or operating any motorized vehicle. It may create a traffic hazard and is illegal in some areas. It can also be potentially dangerous to play your headphones/earphones at high volume while walking, especially at pedestrian crossings. You should exercise extreme caution or discontinue use in potentially hazardous situations.

#### Preventing hearing damage

Do not use headphones/earphones at high volume. Hearing experts advise against continuous, loud and extended play. If you experience a ringing in your ears, reduce the volume or discontinue use.

#### Caring for others

Keep the volume at a moderate level. This will allow you to hear outside sounds and to be considerate to the people around you.

#### On maintenance

- Clean the tape head and tape path using a cotton swab and commercially available cleaning solvent after every 10 hours of use.
- To clean the exterior, use a soft cloth slightly moistened in water. Do not use alcohol, benzine or thinner.
- Clean the headphones/earphones plugs periodically.

This warranty is valid only in the United States.

**SONY** Tape Cassette Player/Recorder/CD Player/Mini Disc  
DAT/Radio/Head Phone/Speaker/MIC/Personals

Portable Audio

## LIMITED WARRANTY

Sony Electronics Inc. ("Sony") warrants this Product (including any accessories) against defects in material or workmanship as follows:

1. LABOR: For a period of 90 days from the date of purchase, if this Product is determined to be defective, Sony will repair or replace the Product, at its option, at no charge, or pay the labor charges to any Sony authorized service facility. After the Warranty Period, you must pay for all labor charges.
2. PARTS: In addition, Sony will supply, at no charge, new or rebuilt replacements in exchange for defective parts for a period of one (1) year. After 90 days from the date of purchase, labor for removal and installation is available from Sony authorized service facilities or a Sony Service Center at your expense.

To obtain warranty service, you must take the Product, or deliver the Product freight prepaid, in either its original packaging or packaging affording an equal degree of protection, to any authorized Sony service facility.

This warranty does not cover customer instruction, installation, set up adjustments or signal reception problems.

This warranty does not cover cosmetic damage or damage due to acts of God, accident, misuse, abuse, negligence, commercial use, or modification of, or to any part of the Product, including the antenna. This warranty does not cover damage due to improper operation or maintenance, connection to improper voltage supply, or attempted repair by anyone other than a facility authorized by Sony to service the Product. This warranty does not cover Products sold AS IS or WITH ALL FAULTS, or consumables (such as fuses or batteries). This warranty is valid only in the United States.

Proof of purchase in the form of a bill of sale or receipted invoice which is evidence that the unit is within the Warranty period must be presented to obtain warranty service.

This warranty is invalid if the factory applied serial number has been altered or removed from the Product.

REPAIR OR REPLACEMENT AS PROVIDED UNDER THIS WARRANTY IS THE EXCLUSIVE REMEDY OF THE CONSUMER. SONY SHALL NOT BE LIABLE FOR ANY INCIDENTAL OR CONSEQUENTIAL DAMAGES FOR BREACH OF ANY EXPRESS OR IMPLIED WARRANTY ON THIS PRODUCT, EXCEPT TO THE EXTENT PROHIBITED BY APPLICABLE LAW, ANY IMPLIED WARRANTY OF MERCHANTABILITY OR FITNESS FOR A PARTICULAR PURPOSE ON THIS PRODUCT IS LIMITED IN DURATION TO THE DURATION OF THIS WARRANTY.

Some states do not allow the exclusion or limitation of incidental or consequential damages, or allow limitations on how long an implied warranty lasts, so the above limitations or exclusions may not apply to you. In addition, if you enter into a service contract with the Sony Partnership within 90 days of the date of sale, the limitation on how long an implied warranty lasts does not apply to you. This warranty gives you specific legal rights, and you may have other rights which vary from state to state.

For your convenience, Sony Electronics Inc. has established telephone numbers for frequently asked questions:

To locate the servicer or dealer nearest you, or for service assistance or resolution of a service problem, or for product information or operation, call:

**Sony Customer Information Services Center**  
1-800-222-7669  
or visit the Sony Web Site:  
www.sony.com

For an accessory or part not available from your authorized dealer, call:

1-800-488-SONY (7669)